



# *UniStar P Series*

## **Tower External Battery Cabinet Installation Manual**

### **Models:**

**SC-BP6000T-2**

**SC-BP6000T-3**

**SC-BP1100T-2**

**SC-BP1100T-3**

# ***Table of Contents***

Chapter 1.	Important Safety Instructions .....	2
Chapter 2.	Introduction to the Rear Panel .....	3
2.1.	Rear Panel Descriptions .....	3
Chapter 3.	Installation and Operation .....	4
3.1.	Unpacking .....	4
3.2.	Selecting Installation Position .....	5
3.3.	Installation of Casters Cover .....	5
3.4.	Installation Instructions.....	6
3.5.	Storage Instruction .....	7
	Appendix 1000W External Battery Charger (Optional).....	8

# Chapter 1. Important Safety Instructions

## **SAVE THESE INSTRUCTIONS**

This manual contains important instructions that should be followed during installation and maintenance of the battery bank and batteries.

### ***An Important Notice***

- This battery bank is connected to a UPS. There will be over 240 volts DC at the output terminals when the UPS or DC breaker is turned on.
- Do not try to repair the unit yourself. Contact your local supplier or your warranty will be void.
- To eliminate any overheating of the battery bank, keep all ventilation openings free from obstruction and do not place any foreign objects on top of the battery bank. Keep the battery bank 8 inches away from the wall.
- Make sure the battery bank is installed within the proper environment as specified. (0-40°C and 30-90% non-condensing humidity)
- Do not install the battery bank under direct sunlight. Your warranty will be void if the batteries fail due to overheating.
- This battery bank is designed for indoor use only.
- This battery bank is not designed for use in dusty, corrosive and salty environments.
- The warranty for this battery bank will be void if water or other liquid is spilled or poured directly onto the battery bank. Similarly we do not warrant any damage to the battery bank if foreign objects are deliberately or accidentally inserted into the battery bank enclosure.
- The battery will discharge naturally if the system is not used for a period of time.
- The battery should be recharged every 2-3 months if not used. If this is not done, then the warranty will be null and void. During normal operation, the batteries will be automatically maintained in charged condition.
- Servicing of Batteries Should be Performed or Supervised by Trained Personnel with Knowledge of Batteries and the Required Precautions
- When Replacing Batteries, Replace With the Same Quantity, Type & Capacity.
- CAUTION – Do Not Dispose of Batteries in an open fire. The Battery May Explode.
- CAUTION – Do not open or mutilate the batteries. The electrolyte from the batteries is toxic and harmful to the skin and eyes.
- CAUTION – Risk of Electric Shock – The Battery Circuit is not isolated from AC, hazardous Voltage may exist between battery terminals and ground. Test before touching with bare hands.
- CAUTION – A Battery can present a Risk of Electrical Shock and High Short Circuit Current. The Following Precaution Should be Observed When Working on Batteries:
  - A. Remove watches, rings, or other metal objects.
  - B. Use tools with insulated handles.
  - C. Wear rubber gloves and boots.
  - D. Do not lay tools or metal parts on top of batteries.
  - E. Disconnect charging source prior to connecting or disconnecting battery terminals.

# Chapter 2. Introduction to the Rear Panel

## 2.1. Rear Panel Descriptions

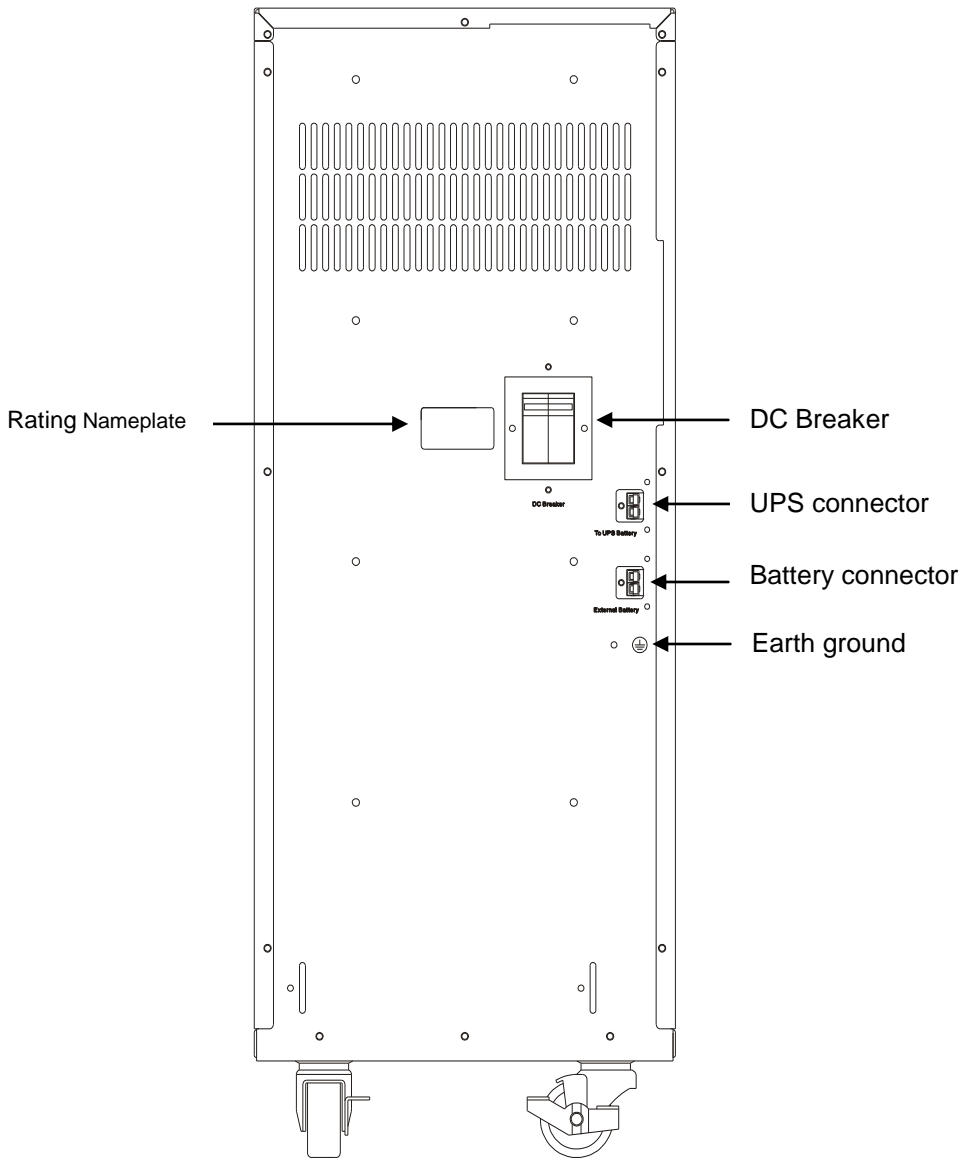

# Chapter 3. Installation and Operation

Note: The condition of the packing material and the external panels of the unit should be inspected carefully before installation. Retain the packing material for future use.

## 3.1. Unpacking

1. Take the battery bank out of the PE foam.
2. Remove the packing materials.

Note: The battery bank module is approx. 264 Lbs. Use caution when unpacking and lifting the unit to avoid injury.

3. Standard Package includes:
  - a. User's Manual
  - b. DC connection cable.
  - c. A pair of kits to attach DC connection cable
  - d. Earth Ground Cord.

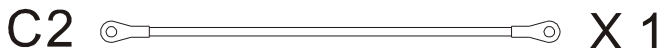
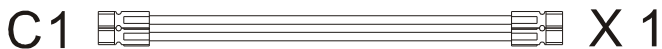

### 3.2. Selecting Installation Position

It is necessary to select a proper environment to install the unit in order to minimize the possibility of damage to the battery bank and extend the life of the batteries. Please follow the instructions below:

1. Keep at least 8 inches clearance from the rear panel of the battery bank from the wall or other obstructions.
2. Do not block the air-flow to the ventilation openings of the unit.
3. Please ensure the installation site environmental conditions are in accordance with the battery bank working specifications to avoid overheating and excessive moisture.
4. Do not place the battery bank in a dusty or corrosive environment or near any flammable objects.
5. This battery bank is not designed for outdoor use.

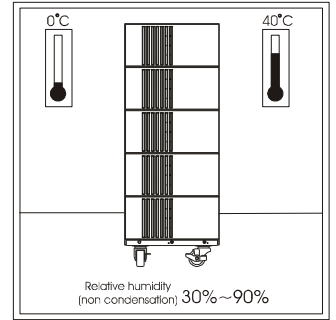
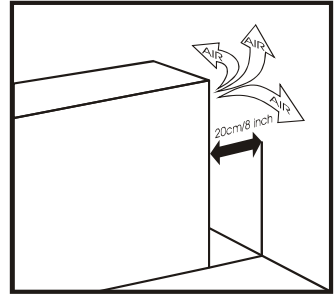

### 3.3. Installation of Casters Cover

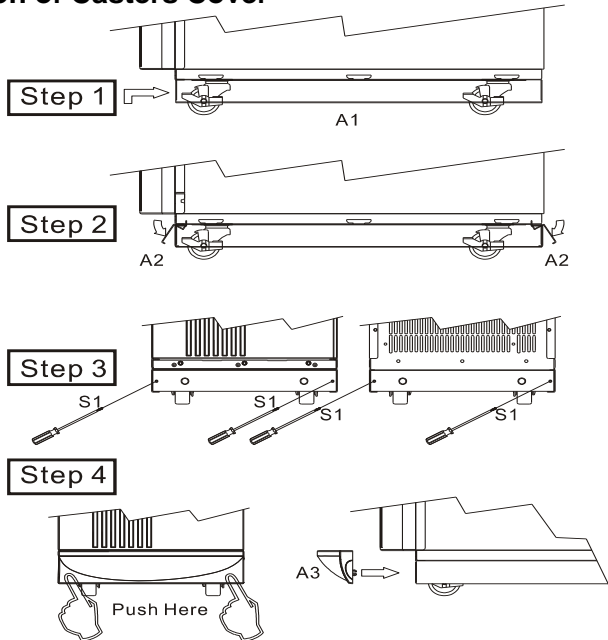

### 3.4. Installation Instructions

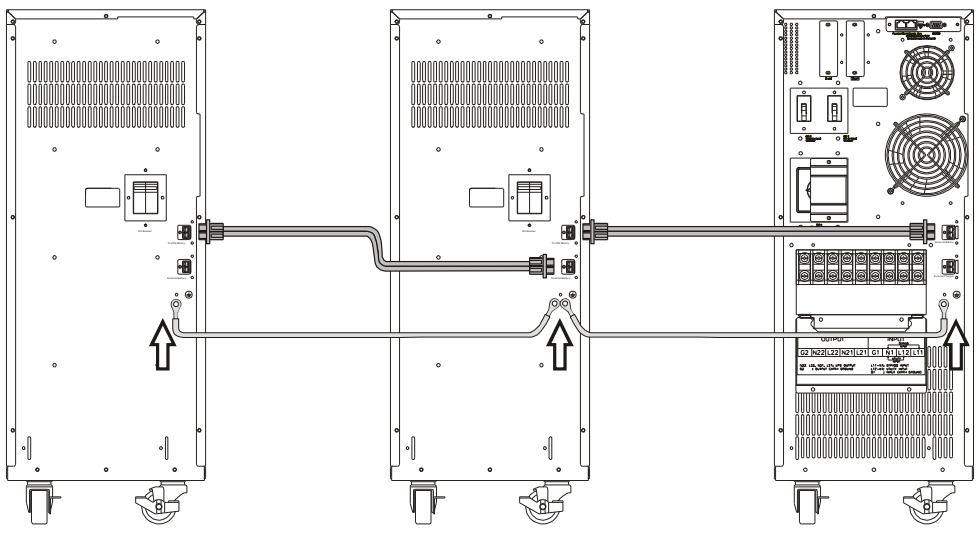
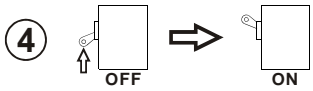
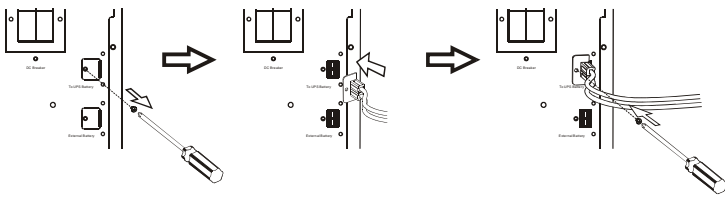
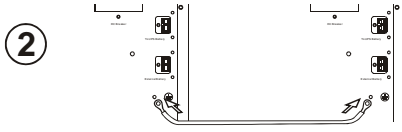
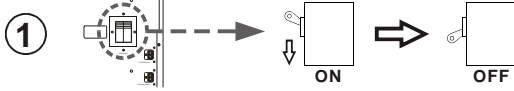

2nd Battery Bank

1st Battery Bank

UPS

## **Storage Instructions**

For extended storage through moderate climate(-15 to +30 °C / +5 to +86 °F), the batteries should be charged for 12 hours every 6 months by plugging the UPS power cord into the wall receptacle. Repeat this every 3 months under high temperature (+30 to +45 °C / +86 to +113 °F) environment.

# 1000W External Battery Charger (SCCH1000)

## Appendix

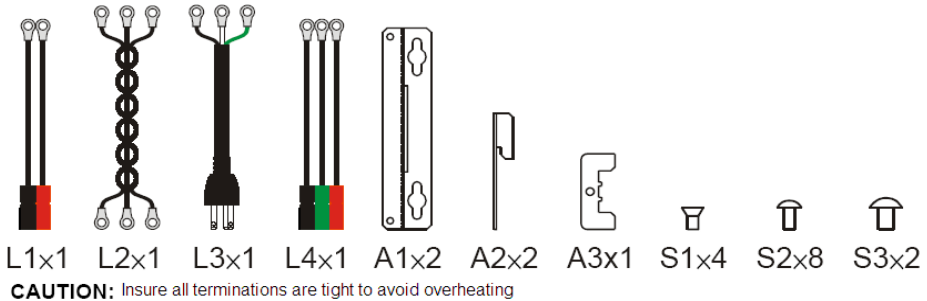

## Placement of the Unit

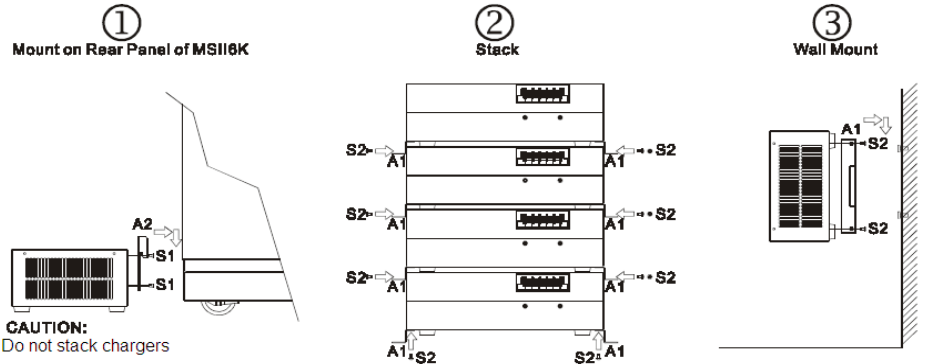

## Set up

### 1 Tower: Connect Utility and DC Plug

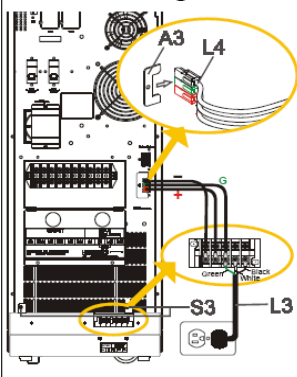

### 2 RT: Connect Utility and DC Plug

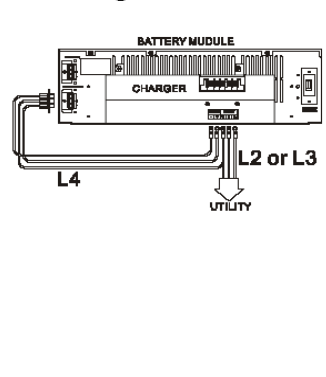

## Parallel Connection

◎ **Number of parallel unit is up to 4.**

- Use UL1015 16 AWG wire when connecting 2 1000 WATT chargers in parallel.
- Use UL 1015 14 AWG wire when connecting 3 or 4 1000 WATT charger in parallel.

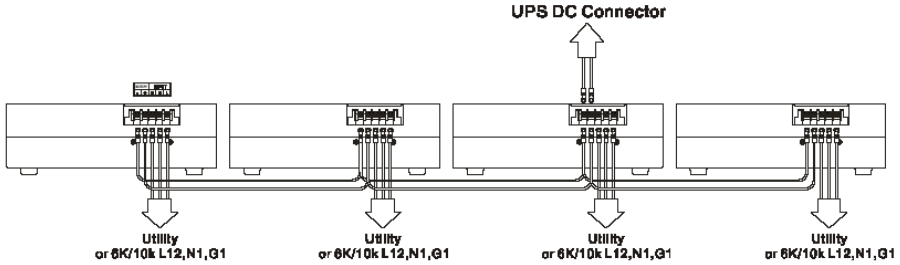

## Specifications

<b>AC INPUT</b>	
Input Voltage	160V-280V
Current	4.6Arms Max.
Freq.	50Hz/60Hz±10%
Power Factor	> 0.85
<b>DC OUTPUT</b>	
Output Voltage	273Vdc ± 3Vdc (NO LOAD)
DC Output Current	5.0A Max.
Power Capacity	1000W Max.
Efficiency	> 0.85 at full load
Power Up Time	< 75ms
Line Regulation	≤ 1%(No LOAD)
Ripple	Approximate ±5V
Noise	Approximate ±3V
<b>ENVIRONMENTAL</b>	
Operation Temperature	0°C ~ 40°C
Cooling	Forced air ventilation by DC fan.
Humidity	10% ~ 90% RH

May parallel to 4000W (maximum input current: 18.4A maximum charging current: 20.0A)

**Staco Energy Products Co.**  
**301 Gaddis Blvd.**  
**Dayton, OH 45403**  
**US Toll Free: 866.261.1191**  
**Fax: 937.253.1723**  
**[www.stacoenergy.com](http://www.stacoenergy.com)**

**003-2283**